

PHASING DIAGRAM

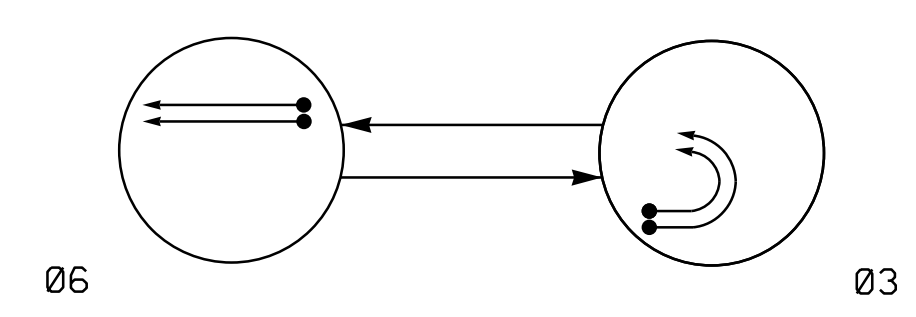

SIGNAL FACE	PHASE		
	Ø3	Ø6	FLASH
31, 32	←	→	↑
61, 62	←	→	↑

SIGNAL FACE I.D.
All Heads L.E.D.

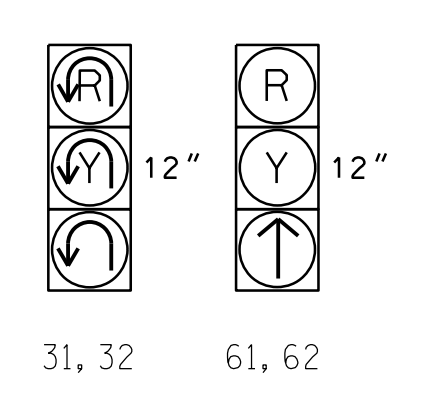

OASIS 2070 LOOP & DETECTOR INSTALLATION CHART												
LOOP	SIZE (FT)	DISTANCE FROM STOPBAR (FT)	TURNS	DETECTOR PROGRAMMING								
				NEW LOOP	PHASE	CALLING	EXTENSION	FULL TIME DELAY	STRETCH TIME	DELAY TIME	SYSTEM LOOP	NEW CARD
3A	6X40	0	2-4-2	Y	3	Y	Y	-	-	-	-	Y
3B	6X40	0	2-4-2	Y	3	Y	Y	-	-	-	-	Y
6A	6X6	420	6	Y	6	Y	Y	-	-	-	-	Y
6B	6X6	420	6	Y	6	Y	Y	-	-	-	-	Y

2 Phase Fully Actuated
(US 64 & Jenks/Richardson Road Closed Loop System)
Signal System: 10534

NOTES

1. Refer to "Roadway Standard Drawings NCDOT" dated January 2018, "Standard Specifications for Roads and Structures" dated January 2018, and all applicable sections of the latest version of the generic Project Special Provisions. The PSP can be accessed at the following website: <http://connect.ncdot.gov/resources/safety/pages/ITS-Design-Resources.aspx>
2. Do not program signal for late night flashing operation unless otherwise directed by the Engineer.
3. Set all detector units to presence mode.
4. Locate new cabinet so as not to obstruct sight distance of vehicles turning right on red.
5. Maximum times shown in timing chart are for free-run operation only. Coordinated signal system timing values supersede these values.
6. Closed loop system data: Controller Asset #1426

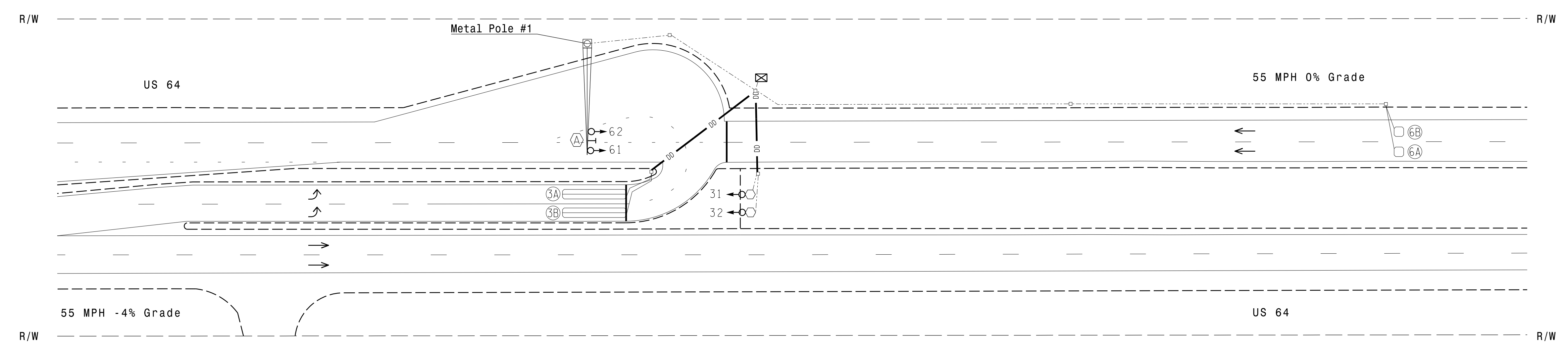

FEATURE	PHASE	
	3	6
Min Green 1 *	7	14
Extension 1 *	2.0	6.0
Max Green 1 *	20	90
Yellow Clearance	3.0	5.2
Red Clearance	3.3	1.0
Walk 1 *	-	-
Don't Walk 1	-	-
Seconds Per Actuation *	-	1.5
Max Variable Initial *	-	46
Time Before Reduction *	-	15
Time To Reduce *	-	45
Minimum Gap	-	3.4
Recall Mode	-	MIN RECALL
Vehicle Call Memory	-	YELLOW
Dual Entry	-	-
Simultaneous Gap	ON	ON

* These values may be field adjusted. Do not adjust Min Green and Extension times for phase 6 lower than what is shown. Min Green for all other phases should not be lower than 4 seconds.

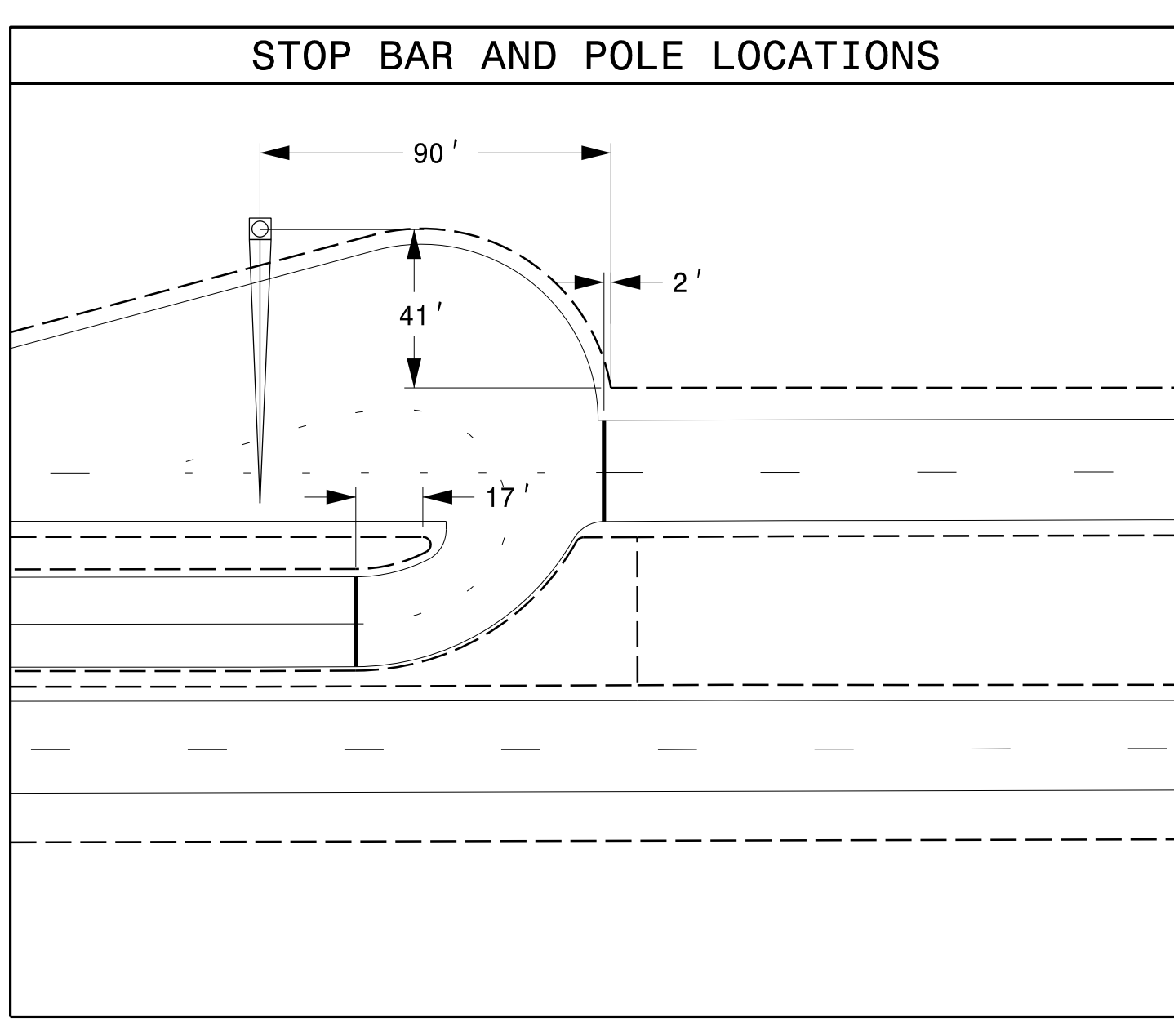

NC Dept of Transportation
Division of Highways
Final Drawing Date: 8/28/2020
Designed by: [Signature]
Checked by: [Signature]
ITS & Signals Unit

PROPOSED	LEGEND	EXISTING
○ →	Traffic Signal Head	● →
○ →	Modified Signal Head	N/A
⊥	Sign	⊥
⊥	Pedestrian Signal Head With Push Button & Sign	⊥
○ →	Signal Pole with Guy	● →
○ →	Signal Pole with Sidewalk Guy	● →
⊠	Inductive Loop Detector	⊠
⊠	Controller & Cabinet	⊠
⊠	Junction Box	⊠
—	2-in Underground Conduit	—
N/A	Right of Way	—
→	Directional Arrow	→
— DD —	Directional Drill	N/A
⊠	No Left Turn Sign (R3-2)	⊠
○	Metal Pole with Mastarm	○
○	Type II Signal Pedestal	○



New Installation

US 64 WB at U-Turn East of Richardson Road

Division 5 Wake County Apex

PLAN DATE: August 2020 REVIEWED BY: WJ Hamilton

PREPARED BY: ZM Esposito RKA PROJ. NO: 19331 (040)

750 N. Greenfield Pkwy, Garner, NC 27529

SCALE: 1" = 40'

REVISIONS: [Table with columns for REVISIONS, INIT., DATE]

DOCUMENT NOT CONSIDERED FINAL UNLESS ALL SIGNATURES COMPLETED

SEAL: NORTH CAROLINA PROFESSIONAL ENGINEER, WILLIAM J. HAMILTON, 32396

DATE: 8/24/2020

SIG. INVENTORY NO. 05-1426