

Bradley Commons

Conveniently situated in the Villages of Apex area, this new construction building could be the perfect fit for small to medium-sized businesses. Located right off US Highway 64, Bradley Commons offers great access to major highways and interstates.



Open Possibilities

Bradley Commons is a quality construction shell building that is zoned light industrial which allows for office, retail, medical as well as restaurant. The structure is a three-story professional office building with 6,000 s.f. per floor. Bradley Commons is perfectly situated near restaurants and shops located in Historic Downtown Apex and is only a few miles from US Highway 1.

Floor Plan

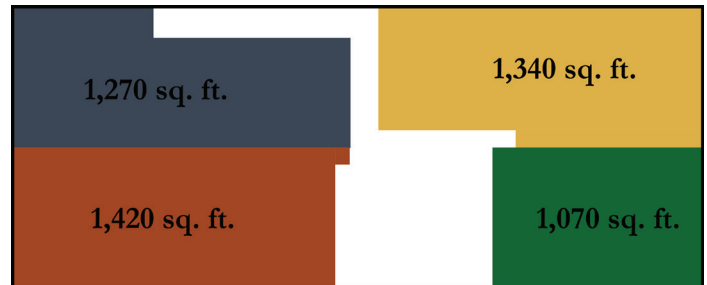

The second and third floor have the same layout, which is depicted above.

For sales and leasing information, please contact:
 Tom Colhoun
 Colhoun Real Estate LLC
 (919)-267-6928



For more information about locating your business in Apex, featured properties, or other processes of the Town, please contact Joanna Helms, Economic Development Director at 919-372-7461 or joanna.helms@apexnc.org.